

## Air reservoir front part assembly

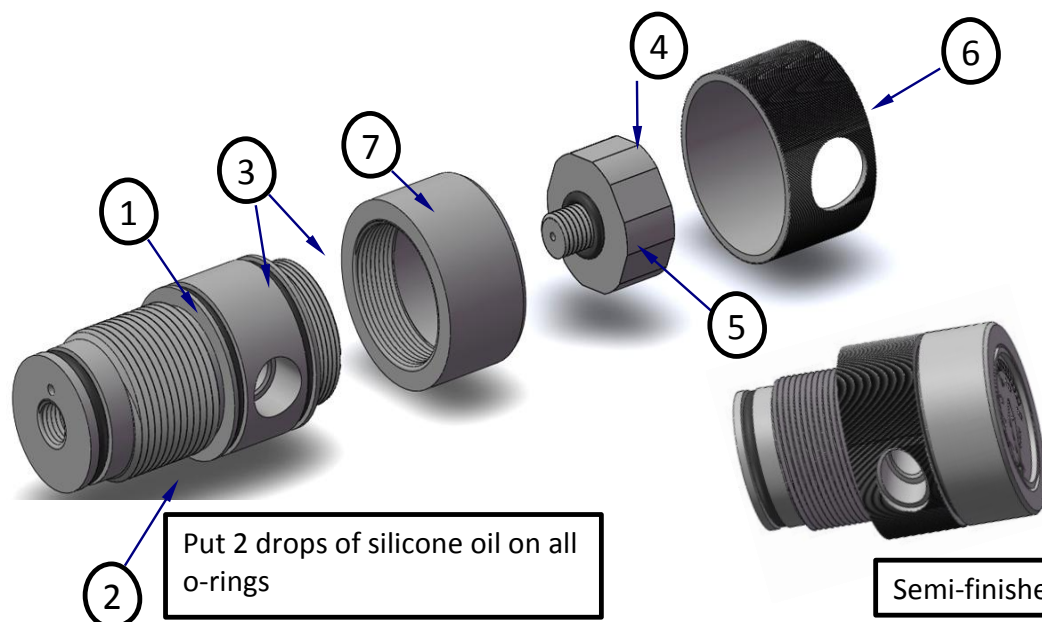

NO.	DESCRIPTION	ITEM CODE	USE QTY	Remarks
1	Air reservoir front plug	000P1-005-W-01	1	
2	O ring $\phi 24 \times \phi 3$ hardness 90°	000P1-006-X-00	1	
3	O ring $\phi 30 \times \phi 2$ hardness 70°	000P1-035-X-00	2	
4	P1 Pressure gauge (Color)	000P1-002-W-00	1	
5	O ring $\phi 8 \times \phi 2$ hardness 90° JSR	000P2-065-X-00	1	
6	Air reservoir front plug ring	000P1-017-W-00	1	
7	Pressure gauge protective cap	000P1-055-W-00	1	

## Air reservoir overall assembly

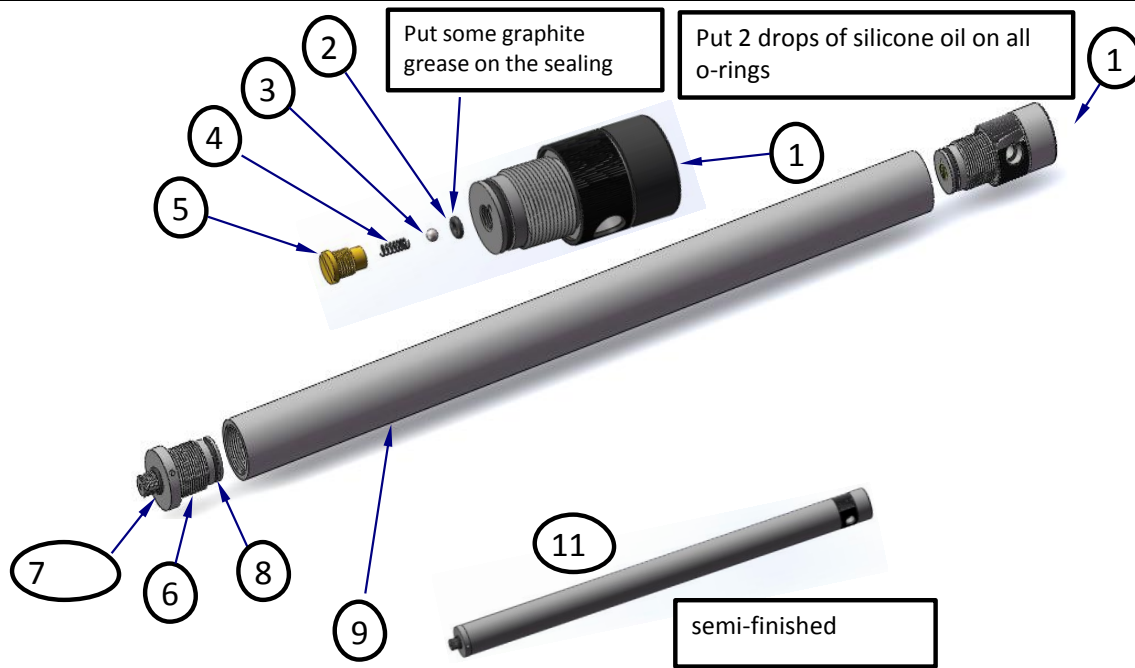

NO.	DESCRIPTION	ITEM CODE	USE QTY	Remarks
1	Air reservoir front plug Semi-finished product	/	1	
2	O ring $\phi 2.5 \times \phi 2.5$ hardness $90^\circ$ JSR	PS-014-X-00	1	
3	Steel ball $\phi 4$	000P2-054-W-00	1	
4	Air reservoir front plug check valve spring	000P2-179-W-00	1	
5	Air reservoir front plug check valve screw	000P1-019-W-01	1	
6	Air reservoir rear plug	000P1-007-W-01	1	
7	O ring $\phi 2.5 \times \phi 15$ hardness $90^\circ$ NBR	000P1-026-X-00	1	
8	O ring $\phi 3 \times \phi 24$ hardness $70^\circ$ NBR	000P1-006-X-00	1	
9	Air reservoir tube	000P1-006-W-00	1	
10	Air reservoir front plug Semi-finished product	/	1	
11	Air reservoir Semi-finished product ( 300 bar)			

## Pellet probe assembly

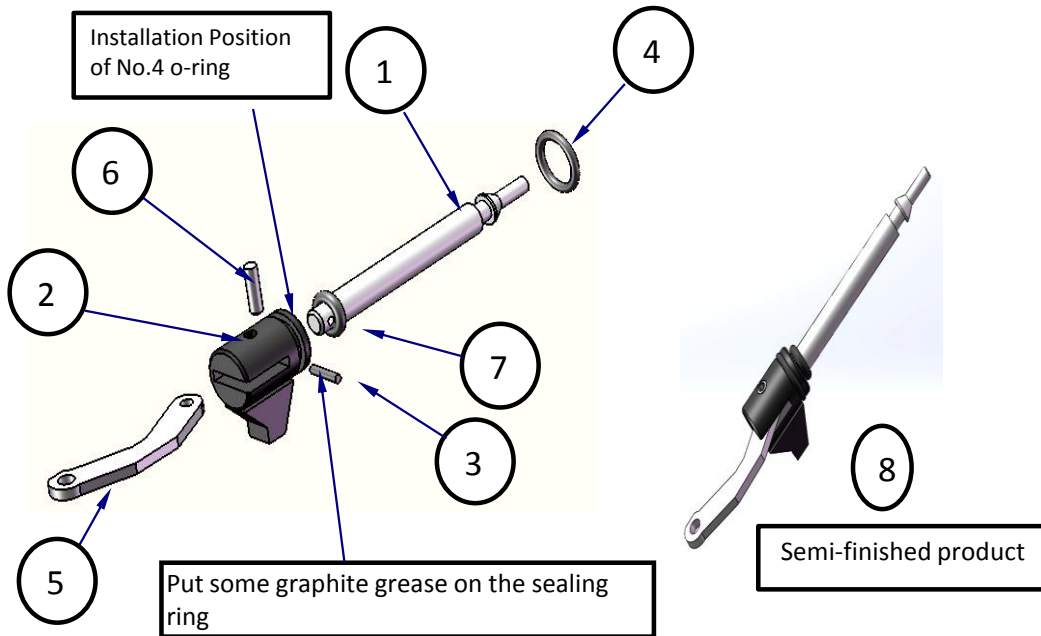

NO.	DESCRIPTION	ITEM CODE	USE QTY	Remarks
1	Cal 5.5mm Pellet probe	000P1-028-W-00	1	
2	Pellet probe seat	000P2-182-W-00	1	
3	Pellet probe pin $\phi 1.5 \times 7$	000P2-064-W-00	1	
4	O ring $\phi 8 \times \phi 1.5$ hardness 90°JSR	PS-011-X-00	1	
5	Side lever action connecting rod	000P2-061-W-01	1	
6	Side lever action connecting rod front pin	000P2-183-W-00	1	
7	O ring $\phi 5 \times \phi 2.5$ hardness 90°JSR	PS-002-X-00	1	
8	Pellet probe semi-finished product 4.5mm			
8	Pellet probe semi-finished product 5.5mm			
8	Pellet probe semi-finished product 6.35mm			

## Hammer and spring assembly

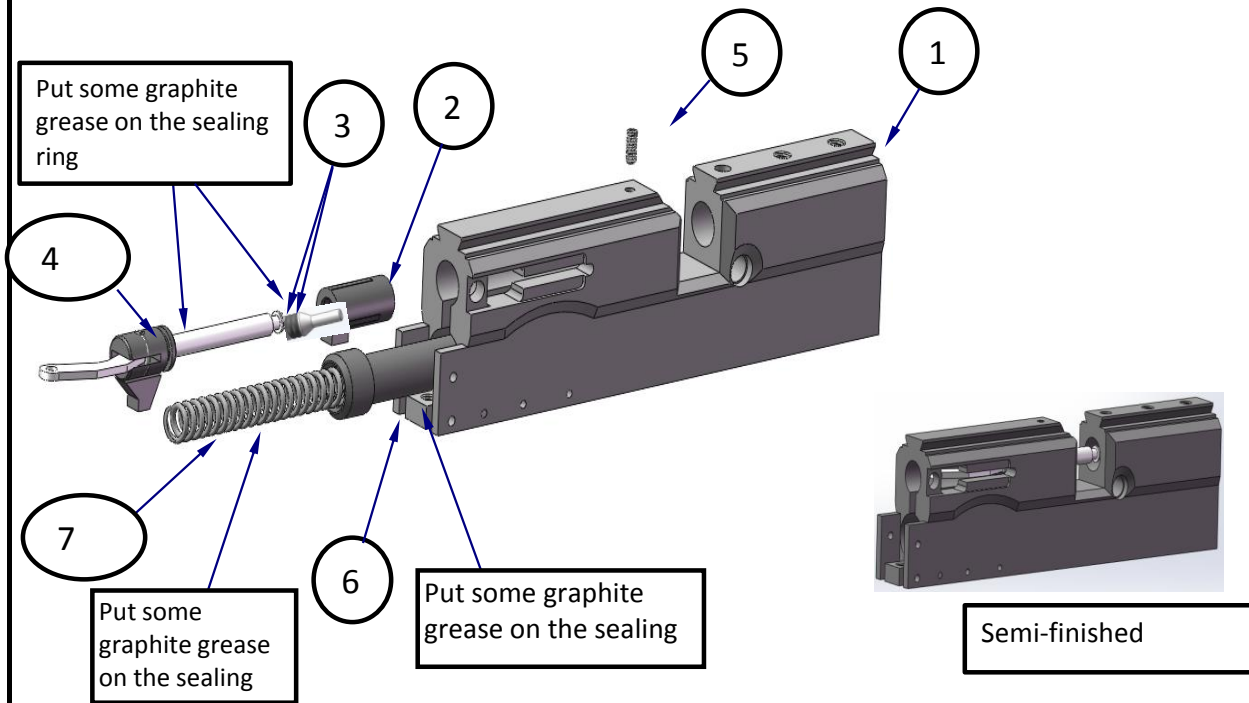

NO.	DESCRIPTION	ITEM CODE	USE QTY	REMARKS
1	Aluminum valve body	/	1	
2	Cal 4.5mm Pellet probe cap	000P2-025-S-00	1	
2	Cal 5.5mm Pellet probe cap	000P1-008-S-00	1	
2	Cal 6.35mm Pellet probe cap	000P1-083-S-00	1	
3	Cal 4.5mm HPA2-4 O ring	0PCP1-001-X-00	2	
3	Cal 5.5mm O ring $\phi 2.5 * \phi 1.5$ hardness 90° JSR	PS-012-X-00	2	
3	Cal 6.35mm O ring $\phi 3 * \phi 1.5$ hardness 90° JSR	PS-010-X-00	2	
4	Pellet probe Semi-finished product	/	1	
5	Cone point allen screw M3*8	000P1-060-W-00	1	
6	P1P2 Hammer	000P1-059-W-00	1	
7	P1 Hammer spring(6.35 )	000P1-093-W-00	1	

Power adjustment valve assembly

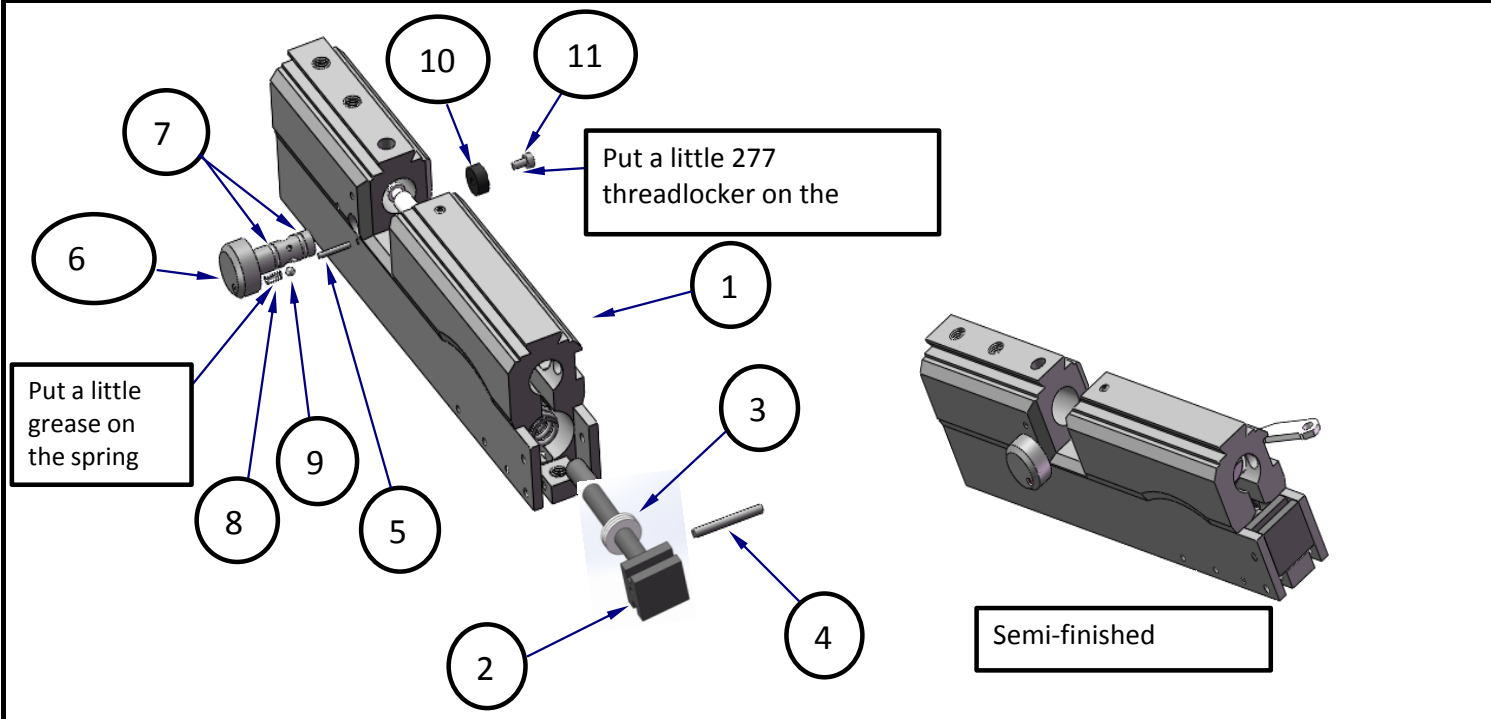

NO.	DESCRIPTION	ITEM CODE	USE QTY	Remarks
1	Side lever action Semi-finished product aluminum valve body	/	1	
2	Cocking spring washer	000P1-066-W-00	3	
3	P1 Cocking bracket 2	000P1-010-S-00	1	
4	Aluminum valve body horizontal pin 2	000P1-085-W-00	1	
5	Steel pin	000P1-027-W-01	1	
6	Cal 5.5mm Power adjustment valve	000P1-026-W-01	1	
7	O ring ODφ7*φ1.5 hardness 70° black	000P2-031-X-00	2	
8	Power adjustment valve spring	000P2-045-W-00	1	
9	Bearing steel ball φ2.5	000P2-136-W-00	1	
10	Power adjustment valve washer	000P2-005-S-00	1	
11	Round head allen screw M2X4	000P2-042-W-00	1	

## Side lever action handle assembly

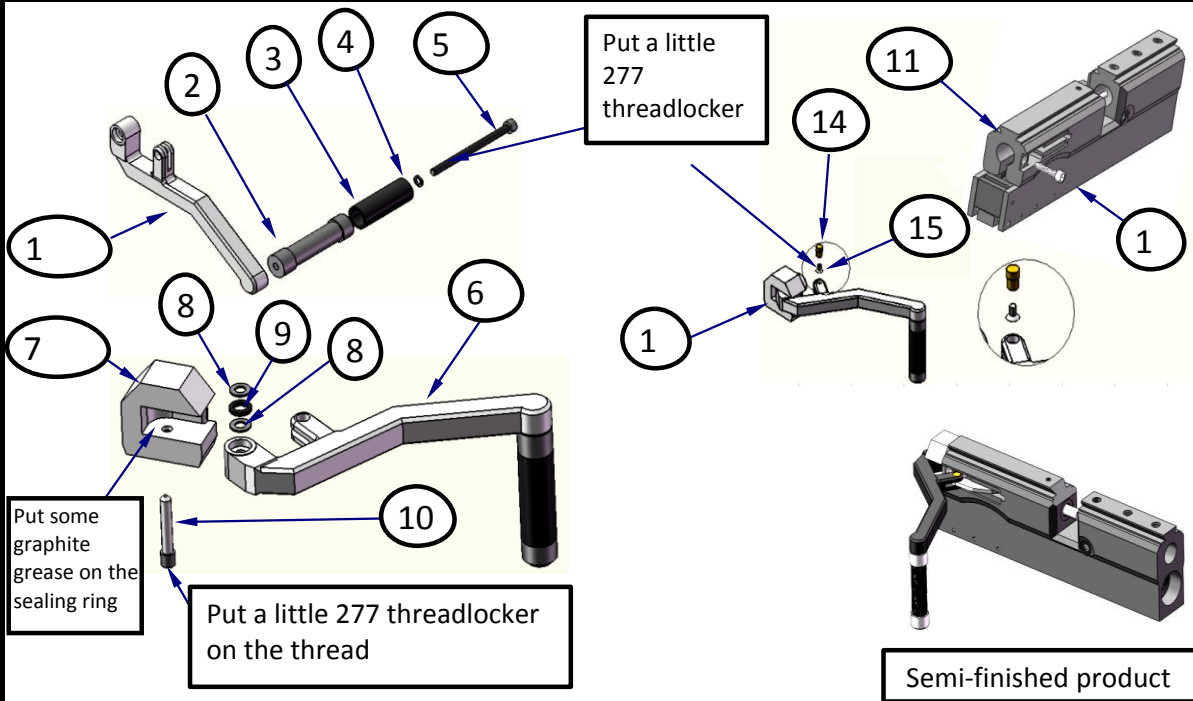

NO.	DESCRIPTION	ITEM CODE	USE QTY	REMARKS
1	Side lever action pull rod (vertical)	000P2-063-W-00	1	
2	Side lever action handle	000P2-133-W-00	1	
3	Side lever action handle sleeve	000P2-040-X-00	1	
4	Standard spring washer ( M3 )	000P2-135-W-00	1	
5	M3X45 Round head allen screw	000P2-134-W-00	1	
6	Side lever action pull rod Semi-finished product	/	1	
7	Cocking bracket 1	000P2-082-W-00	1	
8	Small flat washer ( M3 )	000P2-066-W-00	1	
9	Standard spring washer ( M4 )	000P2-067-W-00	2	
10	Cocking bracket 1 vertical pin	000P2-084-W-00	1	
11	Aluminum valve body semi-finished product	/	1	
12	Side lever action pull rod Semi-finished product	/	1	
13	M3*13 Round head allen screw	000P1-065-W-00	1	
14	Side lever action pull rod rear screw	000P2-062-W-00	1	
15	Flat head philips screw	000P2-065-W-00	1	
(12+14+15)	side lever action pull rod assembly			

## Safety assembly

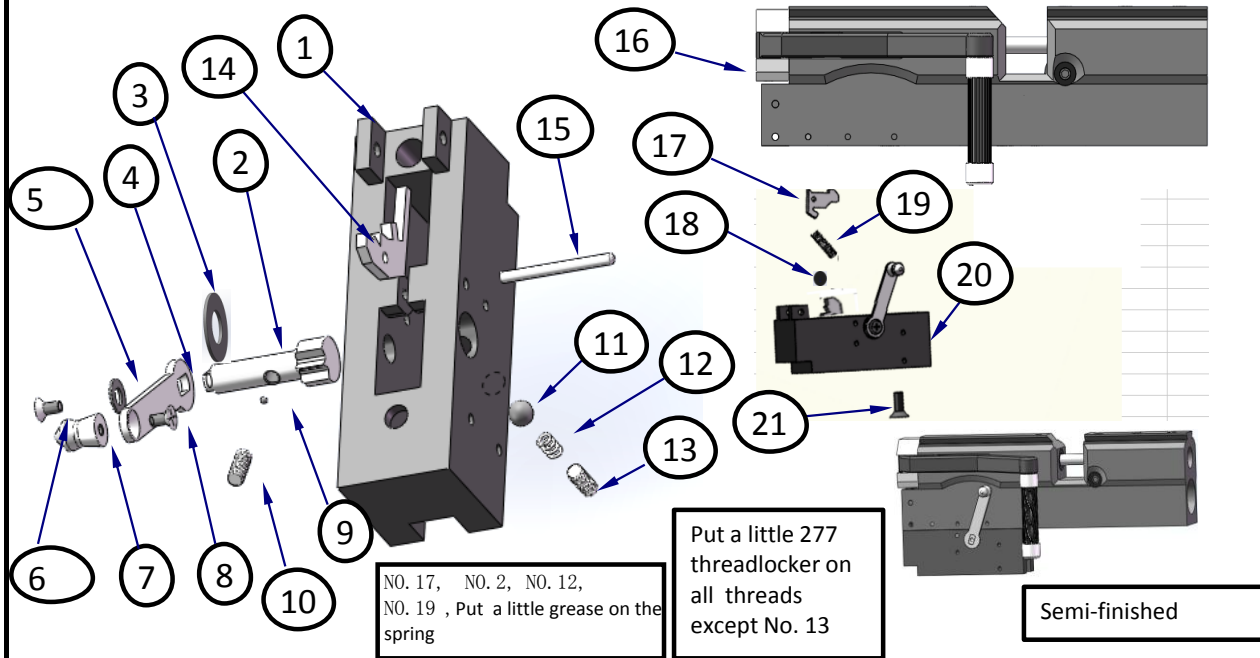

NO.	DESCRIPTION	TIME CODE	USE QTY	REMARKS
1	Cocking bracket 3	000P2-008-S-01	1	
2	Safety stem	000P2-073-W-00	1	
3	Safety washer	000P2-160-W-00	1	
4	Safety rod	000P2-069-W-00	1	
5	Flat washer ( M3 )	000P2-066-W-00	1	
6	Flat head philips screw type-Z M2X5	000P2-070-W-00	1	
7	Safety knob	000P2-068-W-00	1	
8	Flat head philips screw type-H M2×5	000P2-070-W-00	1	
9	Steel ball φ1.2	000P2-162-W-00	1	
10	Flat point allen screw M3X10	000P2-089-W-00	1	
11	Bearing steel ball φ4.4	000P2-163-W-00	1	
12	Safety spring	000P2-071-W-00	1	
13	Flat point allen screw M5×5	000P2-155-W-00	1	
14	Trigger iron	000P2-080-W-00	1	
15	Aluminum valve body horizontal pin 1	000P2-091-W-00	1	
16	Aluminum valve body semi-finished product	/	1	
17	Sear	000P2-081-W-00	1	
18	Aluminum valve body horizontal pin 1	000P2-091-W-00	1	
19	Sear spring	000P2-159-W-00	1	
20	Safety semi-finished product	/	1	
21	Flat head allen screw M4×8	000P2-076-W-00	1	

## Trigger and air release valve assembly

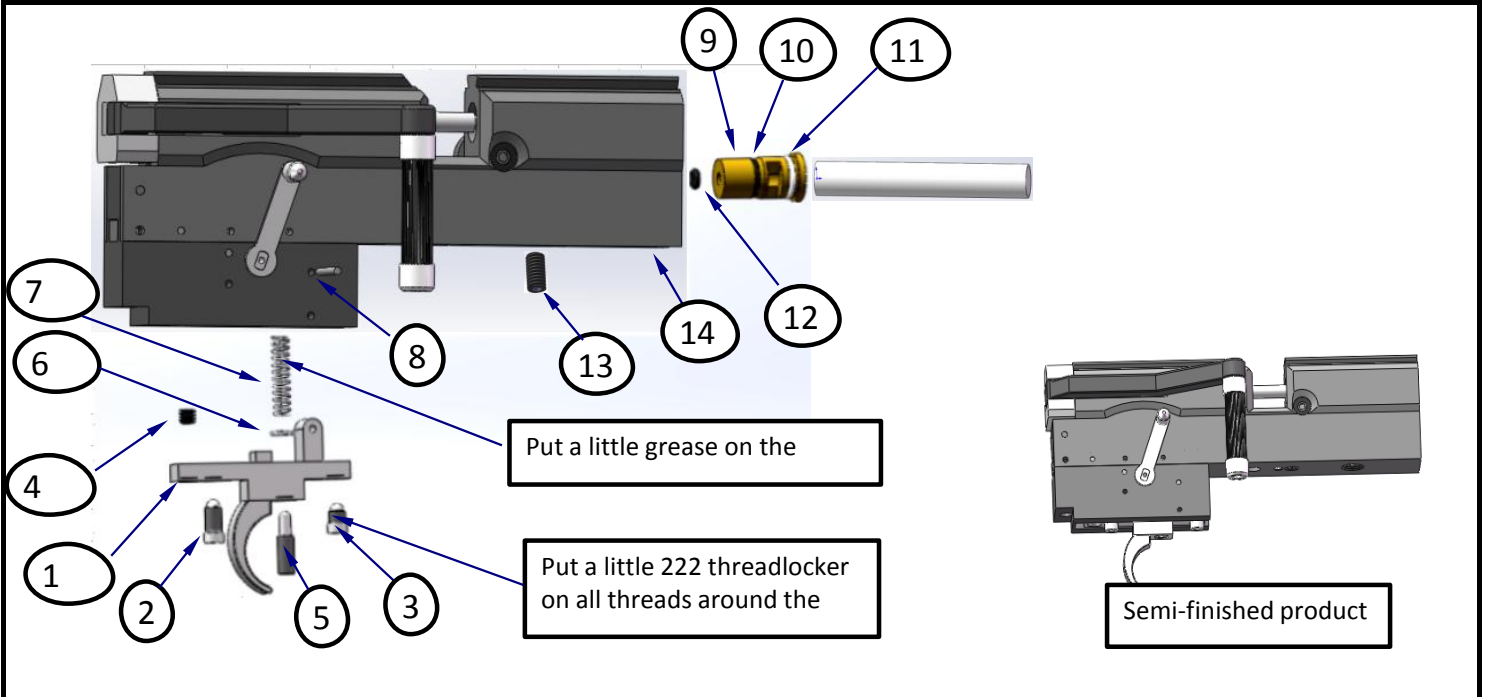

NO.	DESCRIPTION	ITEM CODE	USE QTY	REMARKS
1	Trigger	000P2-074-W-00	1	
2	Trigger bracket adjustment screw 2	000P2-088-W-01	1	
3	E clamp spring	000P2-193-W-00	1	
4	Flat point allen screw M5×4	000P2-161-W-00	1	
5	Trigger pull adjustment screw	000P2-144-W-00	1	
6	Trigger pull adjustment flat washer	000P2-143-W-00	1	
7	Trigger spring	000P2-158-W-00	1	
8	Aluminum valve body horizontal pin 1	000P2-091-W-00	1	
9	Air release valve sleeve	000P2-125-W-00	1	
10	O ring $\phi 8 \times \phi 1.5$ hardness 90° JSR	PS-011-X-00	1	
11	O ring $\phi 8 \times \phi 2$ , hardness 90 JSR	000P2-065-X-00	1	
12	O ring $\phi 3 \times \phi 1.5$ hardness 90° JSR	PS-010-X-00	1	
13	Cone point allen screw M4×8	000P2-059-W-00	1	



## Pressure relief valve front part assembly

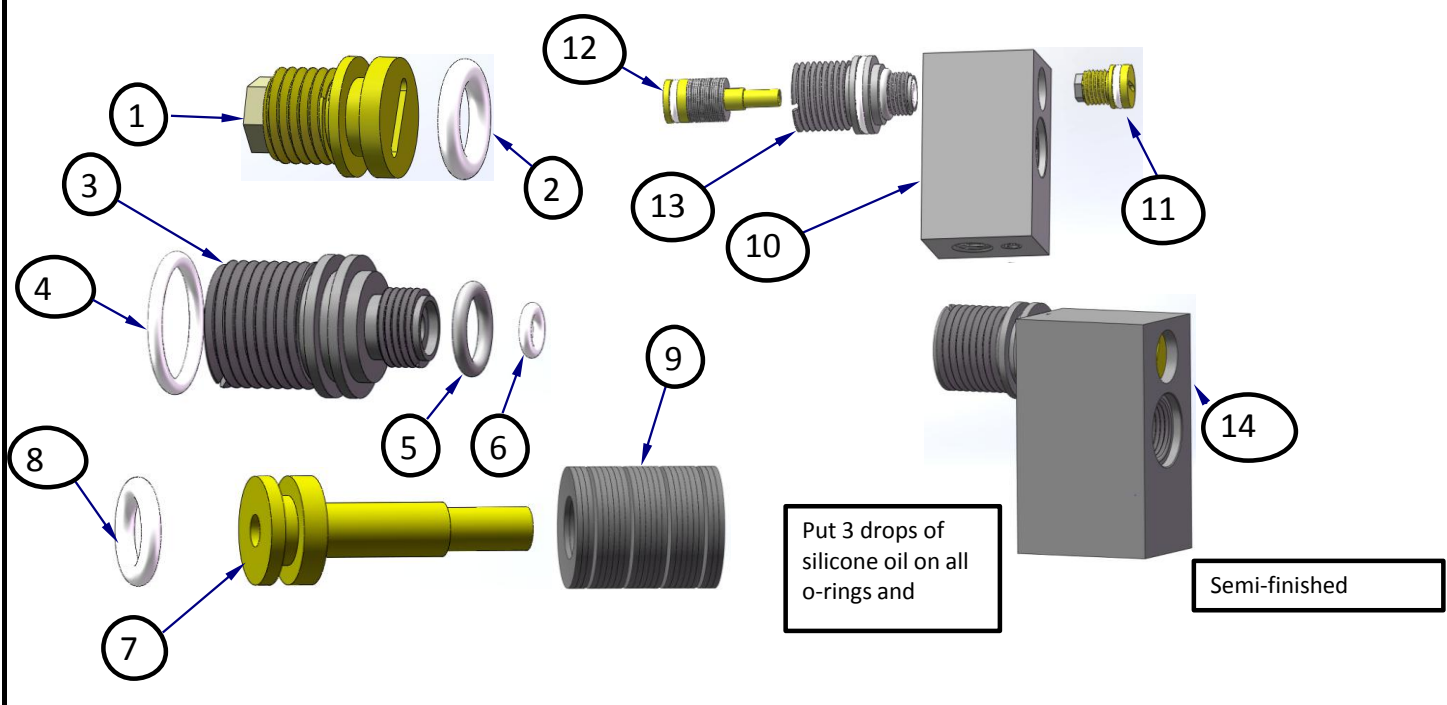

NO.	DESCRIPTION	ITEM CODE	USE QTY	REMARKS
1	Pressure relief valve screw assembly	000P1-021-Z-01	1	
2	O ring $\phi 6^* \phi 2$ hardness 90° JSR	000P2-066-X-00	1	
3	Pressure relief valve connecting sleeve	000P1-011-W-01	1	
4	O ring $\phi 14^* \phi 2$ hardness 90° JSR	000P2-064-X-00	1	
5	O ring $\phi 8^* \phi 2$ hardness 90° JSR	000P2-065-X-00	1	
6	O ring $\phi 3.7^* \phi 1.65$ hardness 90° JSR	000P2-063-X-00	1	
7	Pressure relief valve stem	000P1-010-W-00	1	
8	O ring $\phi 6^* \phi 2$ hardness 90° JSR	000P2-066-X-00	1	
9	Pressure relief valve butterfly spring	000P2-103-W-00	24	
10	Pressure relief valve body	000P1-009-W-01	1	
11	Pressure relief valve screw assembly semi-finished product	/	1	
12	Pressure relief valve stem semi-finished product	/	1	
13	Pressure relief valve connecting sleeve semi-finished product	/	1	
14	pressure relief valve semi-finished product		CC	

## Pressure relief valve rear part assembly

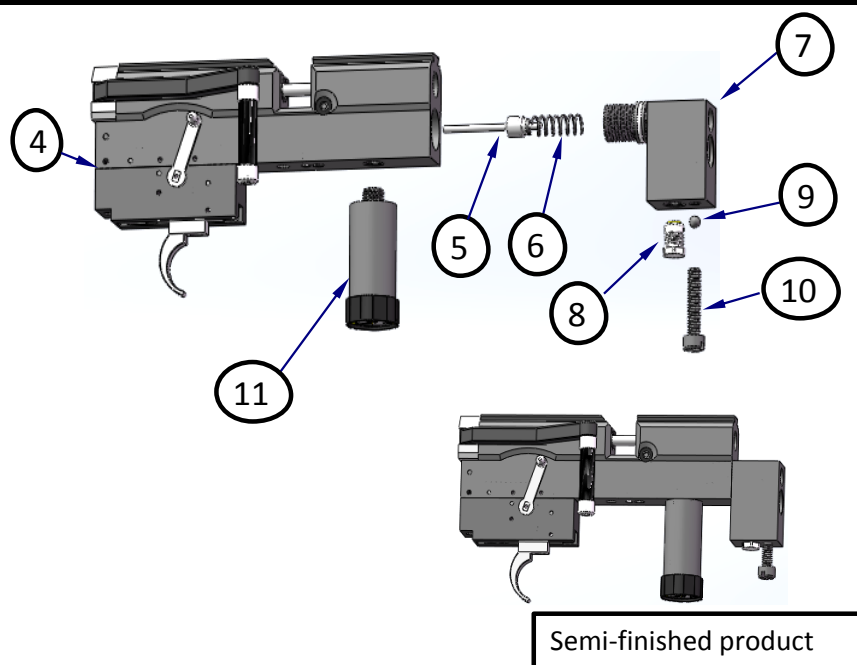

NO.	DESCRIPTION	ITEM CODE	USE QTY	REMARKS
4	Aluminum valve body semi-finished product	/	1	
5	Air release valve stem	/	1	
6	Air release valve spring	000P2-101-W-02	1	
7	Pressure relief valve body semi-finished product	/	1	
8	Safety valve 6K	000P1-022-Z-00	1	
9	Bearing steel ball	000P1-071-W-00	1	
10	Pan head slotted screw (Synthetic stock)	000P1-018-W-00	1	
11	Regulator test clamp			

## Inner barrel assembly

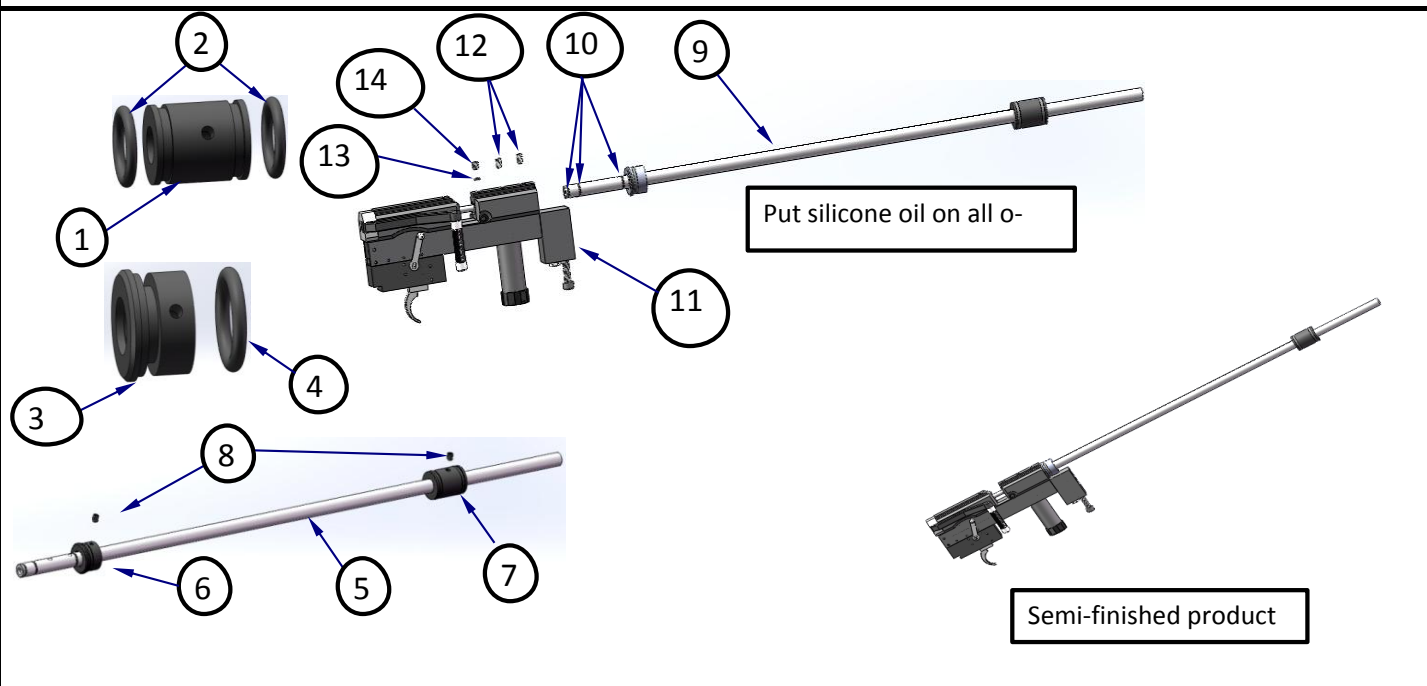

NO.	DESCRIPTION	ITEM CODE	USE QTY	REMARKS
1	Shroud barrel front support sleeve	000P2-003-S-01	1	
2	NBR o-ring $\phi 3 \times 23$ hardness 70°	000P2-028-X-00	1	
3	Shroud barrel rear support sleeve	000P2-004-S-00	1	
4	NBR o-ring $\phi 3 \times 23$ hardness 70°	000P2-028-X-00	1	
5	Inner barrel (cal 5.5mm)	000P1-031-Z-01	1	
6	Shroud barrel rear support sleeve semi-finished product	/	1	
7	Shroud barrel front support sleeve semi-finished product	/	1	
8	Cone point allen screw M4×6×120°(cone)	000P2-036-W-00	2	
9	Inner barrel semi-finished product	/	1	
10	O ring $\phi 8 \times \phi 1.5$ hardness 90° JSR	PS-011-X-00	3	
11	Gun body semi-finished product	/	1	
12	Cone point allen screw M5×8×120°(cone)	000P2-038-W-00	1	
13	O ring $\phi 2.5 \times \phi 1.5$ hardness 90° JSR	PS-012-X-00	1	
14	Cone point allen screw M6×6×120°(cone)	000P2-039-W-00	1	

## Shroud barrel and regulator chamber assembly

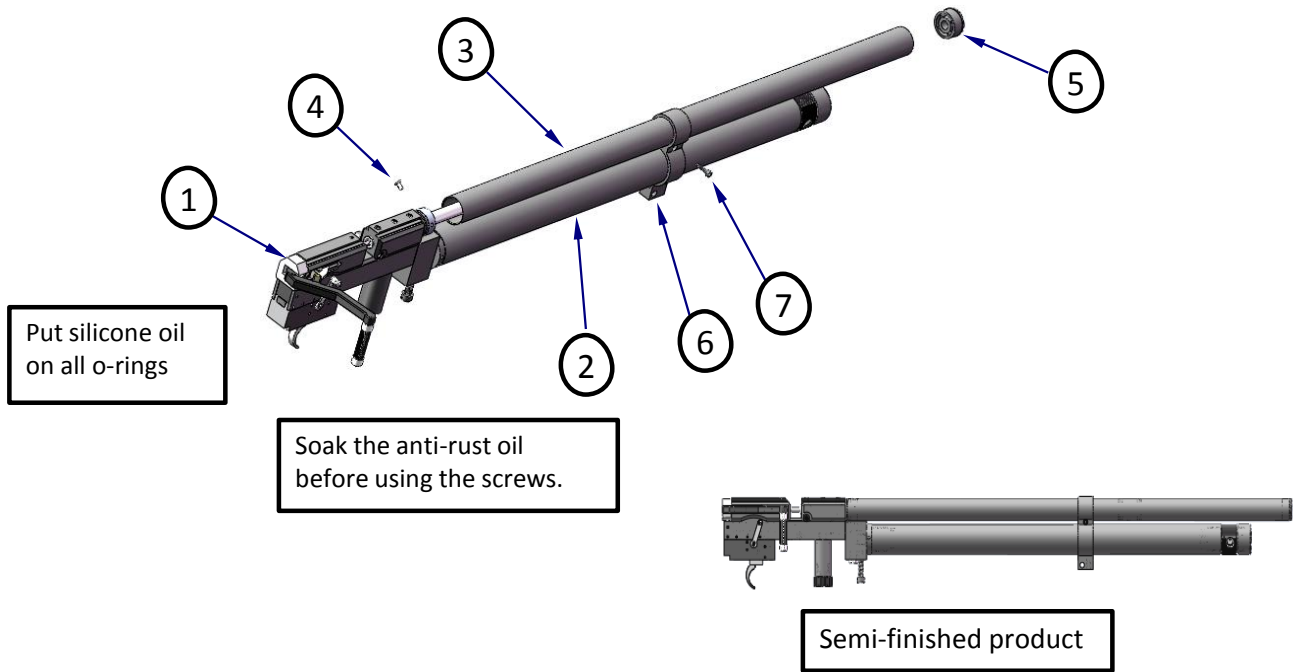

NO.	DESCRIPTION	ITEM CODE	USE QTY	REMARKS
1	Gun body semi-finished product	/	1	
2	Air reservoir Semi-finished product	/	1	
3	Shroud barrel	000P2-035-W-00	1	
4	Flat head allen screw M3×5□	000P2-032-W-00	1	
5	Shroud barrel front plug	000P2-002-S-00	1	
6	Air reservoir front plug ring	000P1-003-W-00	1	
7	Round head allen screw M3*13	000P1-064-W-00	1	

## Leakage and regulator test

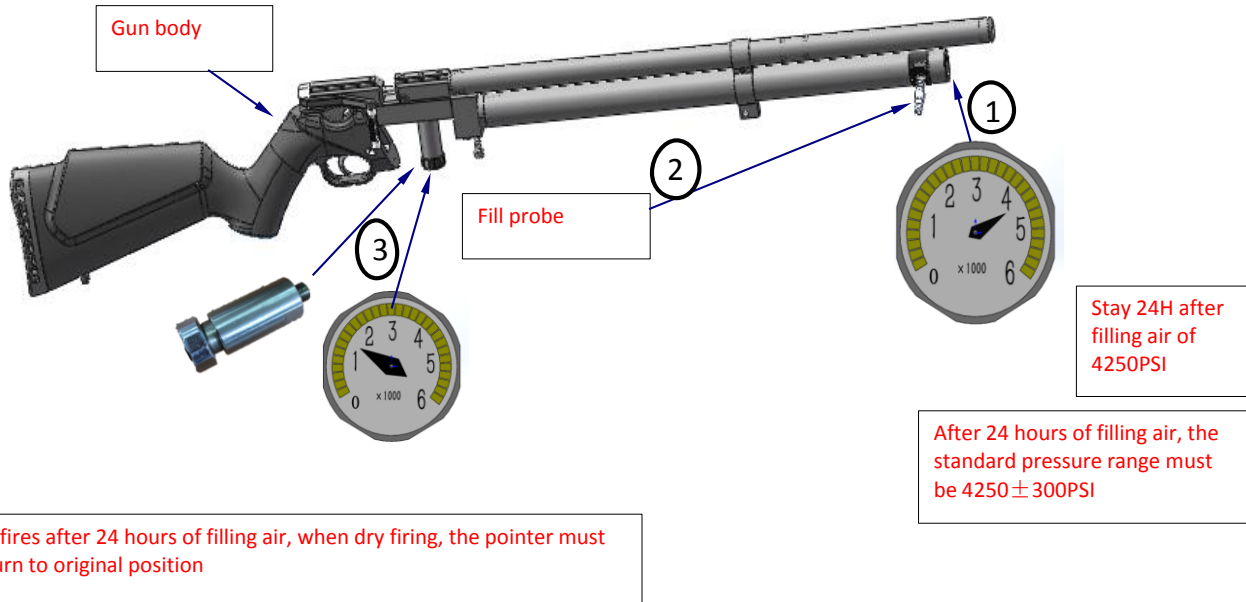

NO	DESCRIPTION	ITEM CODE	USE QTY	REMARKS
1	Air pressure gauge		1	
2	Fill probe		1	
3	Regulator test clamp		1	Used to repair

## Accessories and packaging

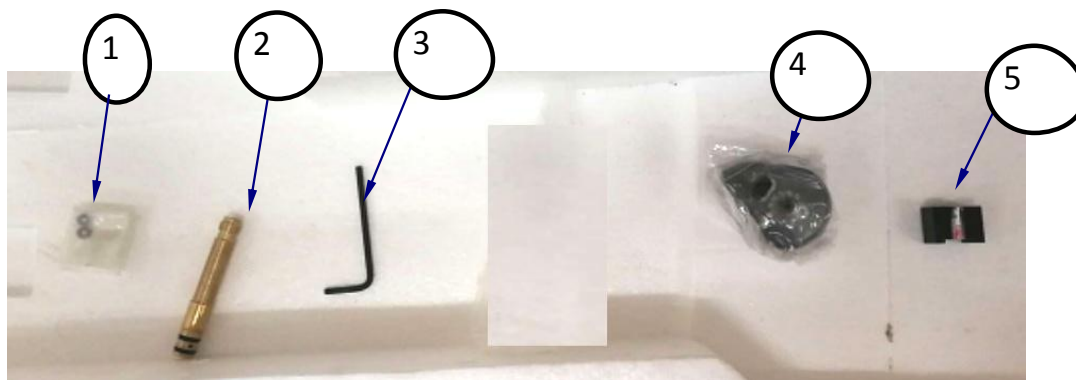

NO	DESCRIPTION	ITEM CODE	USE QTY	REMARKS
1	O ring $\phi 2.5 \times \phi 1.5$ hardness 90° JSR	PS-012-X-00	2	
2	fill probe semi-finished product	/	1	
3	Allen wrench 2.5mm	000P2-128-W-00	1	
4	Rotary Magazine	/	1	
5	Single Shot Trays	/	1	